

# MEDIUM INTENSITY

## MEDIUM INTENSITY OBSTRUCTION LIGHT FOR UK WTGs



According to UK Air Navigation Order 2016, SI 2016/765, lighting of Wind Turbines in UK territorial waters, require Medium Intensity Lights with specific vertical light emission angles.

**LUXSOLAR R&D department has developed a beacon fully complying with such standard, that can be used on all Wind Turbine Generators and Wind Farms located within UK territorial waters.**



# MEDIUM INTENSITY

## MIOL-C WTGs

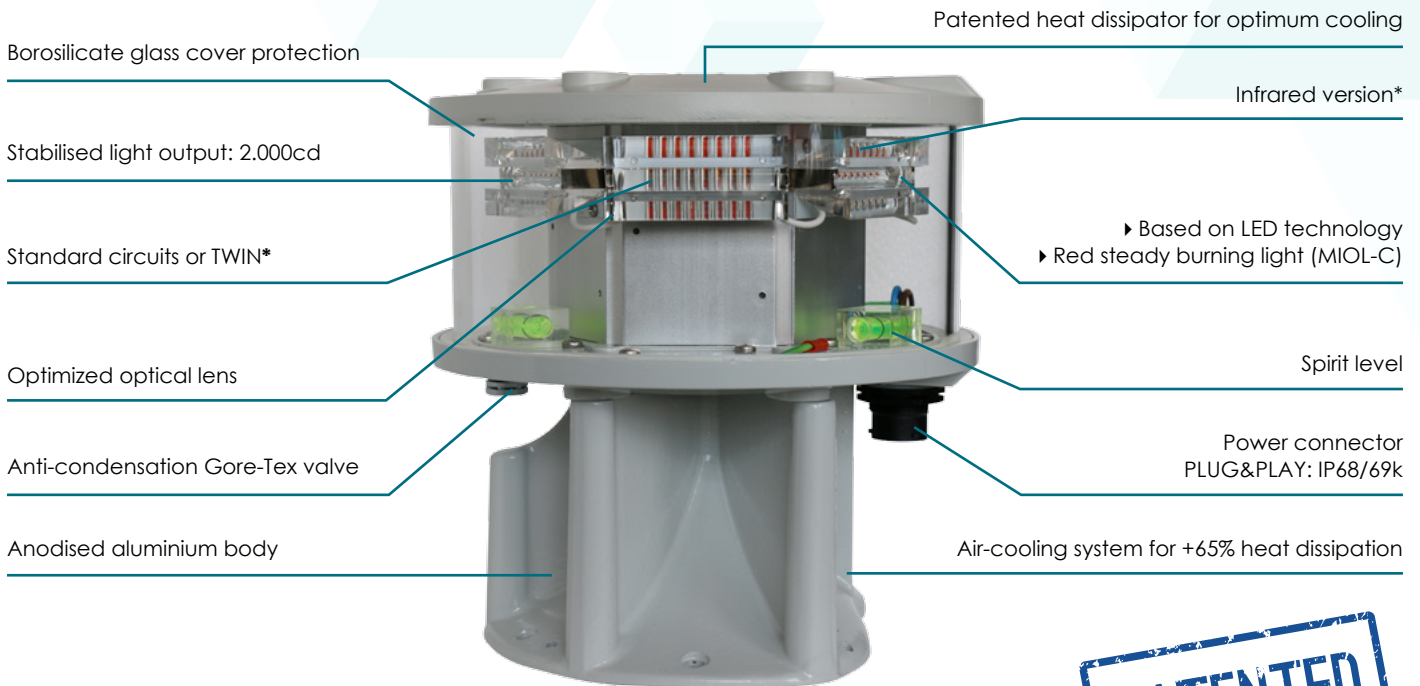

**NOTE: electronic beacon driver in a separate enclosure**

\*as option

**IP66**



LUXSOLAR L864-LXS-WTG Medium Intensity Obstruction Light is **compliant to UK SI2016/765**.

With a **compact body**, high quality and **ultra-bright LEDs**, **customized lenses** and **patented shape for optimum light emission and beacon cooling**, LUXSOLAR L864-LXS-WTG is the most **up-to-dated and technologically advanced Aircraft Warning Light**.

This LED device is designed to **not contain any electronic component** (that is available in a separate control local panel): a huge **advantage in terms of increased life-time and suitability to all environments** (beacons can stand extreme weather conditions) and in terms of an **easy maintenance** (in case of maintenance or periodic checks on electronic components, these can be done at ground or easily accessible levels).

### CERTIFICATION



### COMPLIANCE



### FEATURES

<b>BASE</b> 	<b>COVER</b> 						<b>TYPE C</b> 	<b>OPTION</b> 	<b>TYPE C</b> 

### TYPICAL APPLICATION



# MEDIUM INTENSITY

## MIOL-C WTGs TECHNICAL SPECIFICATIONS

### OPTICAL FEATURES

- Based on LED technology
- RED light 2.000cd
- Cd emission @ -0,5° and +4°
- Horizontal beam radiation: 360°
- Vertical beam spread: 4°
- PMMA lens
- Light output alignment device

### MECHANICAL FEATURES

- Anodised aluminium body, painted RAL7035
- Borosilicate glass cover protection
- Silicon rubber, VMQ
- Base wind collector and internal heat sink for optimum cooling
- Degree of protection: IP66
- Anti-condensation Gore-Tex valve
- Operating temperature: -30°C to +50°C
- Lamp unit weight: 6kg
- SS304 beacon support bracket

### ELECTRICAL FEATURES

- Power supply by LUXSOLAR remote control panel:
  - 12/24 VDC;
  - 48 VDC;
  - 115/230VAC;
  - Other power supply range available;
- Average power consumption for MIOL-C (Steady Burning): 21W
- LED fedded at constant current
- No RF-radiations
- Range section of connectable conductors: 0,5mm<sup>2</sup> to 2,5mm<sup>2</sup>
- Cable outer diameter range: 7mm to 14mm

### OPTIONS

- LUXSOLAR Cloud Monitoring System (inside control panel)
- TWIN version: two separate LED circuits in the same fixture (normal + stand-by)

### APPLY TO

- Wind turbine

### CERTIFICATIONS

- CE marking

### COMPLIANCE

- UK Statutory Instruments SI2016/765, "The Air Navigation Order 2016", Art. 223

### ORDER CODE

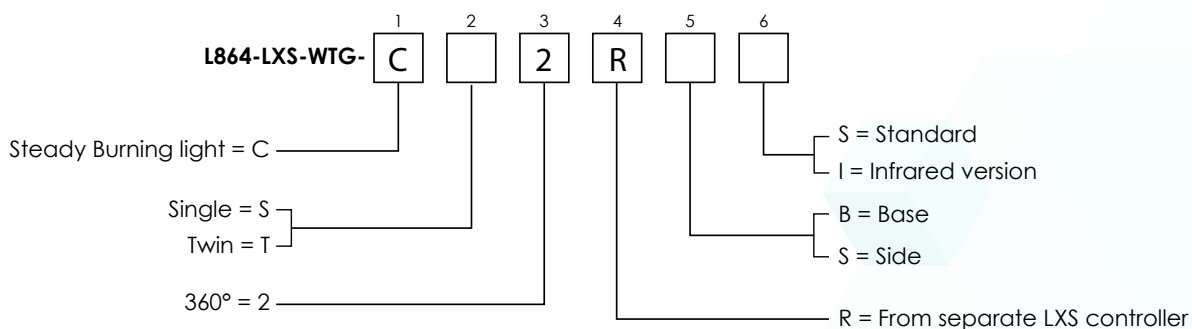

# MEDIUM INTENSITY

## MIOL-C WTGs TECHNICAL SPECIFICATIONS

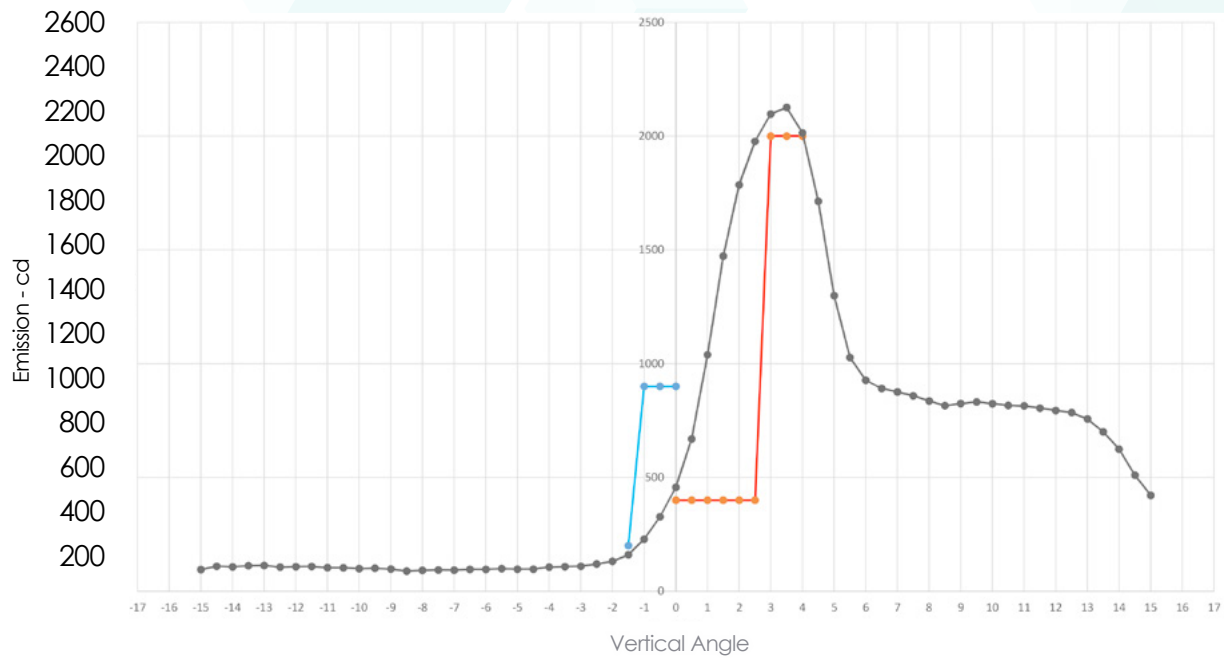

- L864-LXS-WTG average emission level at 90°C ambient temperature
- UK SI2016/765 medium intensity Min. Required Intensity
- UK SI2016/765 medium intensity Max. Required Intensity

SINGLE VERSION  
SIDE VIEW

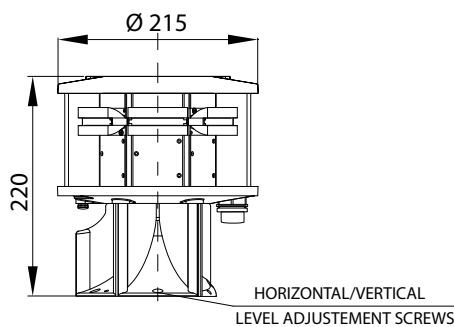

TWIN VERSION  
SIDE VIEW

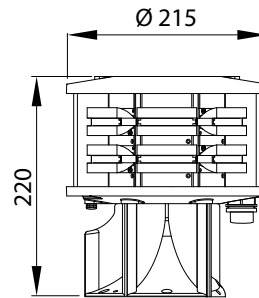

TOP VIEW

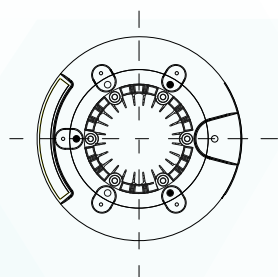

BOTTOM VIEW

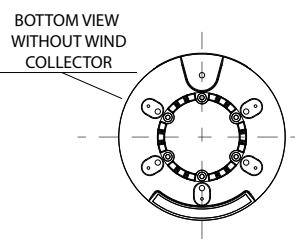
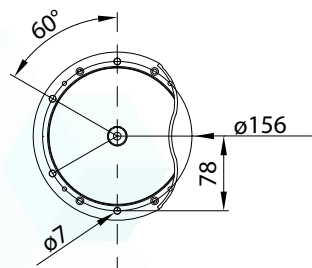

FIXING DETAILS SIDE  
(not scale)

